



Armour Valve



District Heating
Health & Safety
Mining
Oil & Gas
Pulp & Slurry
Power & Steam
Waste Water Treatment

sales@armourvalve.com

1-800-268-3508
fax: 403-245-9297

Armour Valve 
www.armourvalve.com

Armour Valve Ltd. - Alberta



ARI



Air Release Valves

- High air discharge air release valve
- Patented conical body design
- Threaded and flanged ends
- 1" to 8"
- Combination air/vacuum
- Kinetic/automatic air release

AZ-ARMATUREN

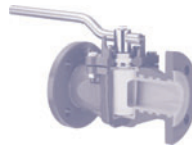

Plug Valves 2-way and Multi-Port Designs

- DI, SS and special alloys
- Sleeved and lines designs
- Self-lubricating/Maintenance free
- Chemical resistant
- Vacuum proof/Cavity free
- Plug easily adjusted
- T_{max}=200°C

BLAC INC.



Electro-Hydraulic Actuators, Control Systems & Power Units for Steam Turbines

- Power units and controls
- Linear and rotary applications
- Consultation available
- Field service capability

BOEHMER



2 Way and Multiport API Pipeline

- Fully welded 2 and 3 piece body
- District heating, gas isolation and control
- Biogas and natural gas
- Double block and bleed
- ½" to 36"
- ANSI 150 to 2500 class

CERA



Ceramic Ball and Sliding Disc Valves, Pipes and Elbows

- For high wear, corrosive and thermal shock applications
- Ceramic seats, balls and liners
- On/off and control applications
- 1" to 8"
- ANSI 150 to 300 class

CONVAL



Camseal Power Ball Valves

- Metal seated, unibody construction
- Zero leakage
- Top entry pressure seal
- Inline renewable
- ½" to 4"
- ANSI 1500 to 4500 class

CONVAL



Clampseal HP Globe Valve

- Globe, check, ball, gate, throttling and tandem blowdown valves

- ½" to 4"
- In-line repairable
- ANSI 900 to 4500 class
- High Temp./Pres. Vents & Drains
- Hydrocarbon drains
- Secondary leak containment

CONVAL



Throttling Valve

- Easy to read position indicator
- Pressure seal bonnet
- Replaceable seat/venturi
- Available in tandem configuration
- ½" through 3"
- Up to 2500 class

EVS Valves



Metal Seated Ball Valves

- Tight shutoff
- Fire safe, severe service
- Various materials/end connections
- ½" to 24"
- ANSI 150 to 4500* class

* Up to 900 class only for Power Industry

EVS Valves



Triple Offset Butterfly Valves

- Carbon steel, stainless steel body
- Flanged and lugged end connections
- 3" to 24"
- ANSI 150, 300, 600 class



Armour Valve



Your trusted supplier of specialty valves and process equipment

HOMESTEAD

AWWA Butterfly Valves

- Cast iron body, ductile iron disc
 - Series 820 - 3" - 24"
 - Series 830 - 24" - 144"
- Eccentric Plug Valves
- Bi-directional design
 - 3" to 72"

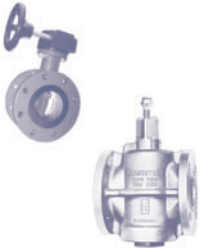

HORA

Automatic Pump Recirculation Valve

- Minimum flow
- Ensures pump protection
- No pneumatic or electrical connections
- 2" to 10"
- ANSI 150 to 1500 class



HORA

Feed Water Control Valves - High and Low Load Designs

- High and low lead designs
- Water, feedwater and steam
- Buttweld or flange connection
- Pneumatic, electric or hydraulic actuation
- 1/2" to 24"
- ANSI 150 to 2500 class



HORA

Multi-Nozzle Desuperheater

- Venturi nozzles atomize spray water
- Integral pressure control
- Electric and pneumatic actuation
- ANSI 300 to 2500 class



HORA

Steam Conditioning Valves for Combined Pressure Reducing and Desuperheating

- Globe, angle or z-style
- Carbon steel, stainless steel and other alloys
- Buttweld or flanged ends
- Up to 1500 class



HORA

Turbine Bypass Systems

- Custom engineered
- 100% of capacity of turbine
- High/Intermediate/Low Pressure

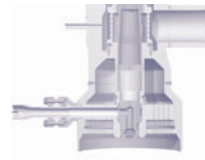

ONYX

Duck Bill Check Valves

- Exterior and inline mounted
- Slip-on
- In-line mounted
- 1" to 24"



ONYX

Pinch Valve

- Full round
- Single pinch
- Pre-pinched
- Air or electric actuators available
- Suitable for buried service
- 1/2" to 30"



PERSTA

High Pressure Valves

- Gate, globe and check
- Forged steel and alloy
- 1/2" and larger
- ANSI 900 to 4500 class



PURETORQ

Rotary Valve Actuators

- High-cycle
- Accurate control
- ISO 5211 mounting
- Fail safe using auxiliary air tank





Armour Valve



Your trusted supplier of specialty valves and process equipment

SCHUF/ FETTEROLF



Cam-Set and Stacey Line Blinds

- Positive isolation
- No flange separation
- Buttweld and flanged ends
- Carbon and stainless steel
- 1" to 36"
- ANSI 150 to 1500 class

SCHUF

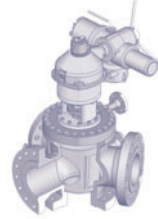

Coker IsoPlug Valves

- Materials CS and C12A (to 36")
 - ANSI 150 to 900 class
- ### Switch Valves
- Materials CS and C12A
 - 3 and 4 outlets at 120 or 90 degrees (to 24")
 - ANSI 150 to 900 class

SCHUF



Sampling Valves

- Metal to metal positive shut-off
- Thermal jacketed optional
- Ram and disc type
- PTFE or graphite packing
- ½" to 96"
- ANSI 150 to 2500 class
- Bottle systems available

SCHUF

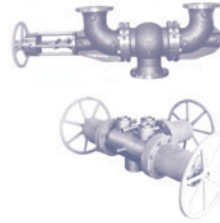

Severe Service Valves

- Flush mounted, bottom outlet, diverter, change over, control and lift plug, ram and disc type

Diverter Valves

- 3/4/5 way options
- Metal to metal seated
- 1" to 10"
- ANSI 150 to 2500 class

SOMAS



Ball Segment Valves Butterfly Valves

- High-performance
- Stainless steel and exotic alloys
- Isolation and control
- Metal and soft seated
- 1" to 48"
- ANSI 150 to 300 class

STAFSJO

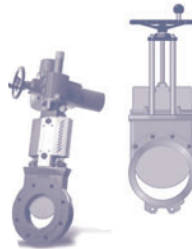

Knife Gate Valves

- Round and square port
- One way and bi-directional
- High-density cleaner valves
- Scavenger valves
- Sewage and pulp valves
- 2" to 48"

STAINLESS VALVE

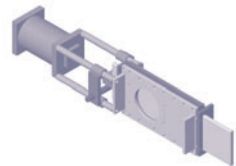

Slide Gate Valves

- Tight shut-off in severe applications
- Custom design flexibility
- Slurry applications

Head Office

126 Milner Avenue
Toronto, ON M1S 3R2
tel: 416-299-0780

Western Region

Office/Stocking Warehouse
6, 2221-41 Avenue NE
Calgary, AB T2E 6P2
tel: 403-229-3171

Field Offices

Atlantic Canada
Quebec
Ontario North
Ontario East
Alberta North
Alberta Central/South
Saskatchewan

Ext.

131
132
133
134
131
110
114



Armour Valve

www.armourvalve.com
sales@armourvalve.com
1-800-268-3508
fax: 416-299-0394

ISO 9001