



Armour Valve



District Heating
Health & Safety
Oil & Gas
Pulp & Slurry
Power & Steam
Waste Water Treatment

Caroline Héon-Roberts
Area Sales Manager
Quebec Region

cheon-roberts@armourvalve.com

1-800-268-3508 x132
fax: 416-299-0394

Armour Valve 
www.armourvalve.com



Armour Valve



Your trusted supplier of specialty valves and process equipment

ARI



Air Release Valves

- High air discharge air release valve
- Patented conical body design
- Threaded and flanged ends
- 1" to 8"
- Combination air/vacuum
- Kinetic/automatic air release

AUMA



Electric Actuators and Valve Gearboxes

- Multi-turn, quarter-turn actuators and gear boxes
- Lever and linear actuators
- Up to 265,000 ft-lb

AZ-ARMATUREN

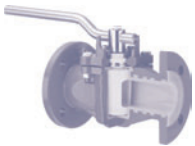

Plug Valves 2-way and Multi-Port Designs

- DI, SS and special alloys
- Sleeved and lines designs
- Self-lubricating/Maintenance free
- Chemical resistant
- Vacuum proof/Cavity free
- Plug easily adjusted
- T_{max}=200°C

BLAC INC.



Electro-Hydraulic Actuators, Control Systems & Power Units for Steam Turbines

- Power units and controls
- Linear and rotary applications
- Consultation available
- Field service capability

BOEHMER



2 Way and Multiport API Pipeline

- Fully welded valves
- Natural gas transmission and distribution
- District heating, oil and gas
- Pipeline ball valve, double block & bleed
- ½" to 36"
- ANSI 150 to 2500 class

CERA



Ceramic Ball and Sliding Disc Valves, Pipes and Elbows

- For high wear, corrosive and thermal shock applications
- Ceramic seats, balls and liners
- On/off and control applications
- 1" to 8"
- ANSI 150 to 300 class

CONVAL



Camseal Power Ball Valves

- Metal seated, unibody construction
- Zero leakage
- Top entry pressure seal
- Inline renewable
- ½" to 4"
- ANSI 1500 to 4500 class

CONVAL



Clampseal HP Globe Valve

- Globe, check, ball, gate, throttling and tandem blowdown valves
- ½" to 4"
- In-line repairable
- ANSI 900 to 4500 class

CONVAL/ HILTAP



High Pressure/High Temperature Vents and Drains

- Hydrocarbon drains
- Secondary leak containment

EBRO



Butterfly Valves

- Resilient seated
- PTFE lined
- High-performance
- Metal and PTFE seated
- Designed for abrasive services
- Wide range of materials available
- Wafer, double flanged and lugged
- ¾" to 48"



FOSSIL POWER SYSTEMS

Aquarian Electronic Level Gauge



- Conductivity sensing
- Modified Swagelok probes
- Alarms and boiler trips
- Up to 3000 psi

FOSSIL POWER SYSTEMS

Aquarian Visual Level Gauge



- Wide range of visibility
- Bi-colour LED illumination
- Thermally compensated port seals
- Up to 3000 psi
- ASME Code compliant

HILTAP

RapidLok™ Series Safety Quick Coupling



- Metal to metal seal
- Leakproof operation
- Safe venting of residual pressure
- ¼" to 6"
- Equal to ANSI 900/1500/2500

HOMESTEAD

AWWA Butterfly Valves



- Series 820 - 3" to 24"
- Series 830 - 24" to 144"
- Cast iron body
- Ductile iron disc
- Bi-directional bubble tight shut off
- Standard pressure class 150

HOMESTEAD

Eccentric Plug Valves

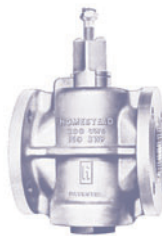

- For waste water and water applications
- Bi-directional design
- Full-size bore and epoxy-coated inside and out
- 3" to 72"

HORA

Automatic Pump Recirculation Valve

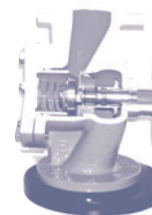

- Minimum flow
- Ensures pump protection
- No pneumatic or electrical connections
- 2" to 10"
- ANSI 150 to 1500 class

HORA

Feed Water Control Valves - High and Low Load Designs



- High and low load designs
- Water, feedwater and steam
- Butt weld or flange connection
- Pneumatic, electric or hydraulic actuation
- ½" to 24"
- ANSI 150 to 2500 class

HORA

Multi-Nozzle Desuperheater



- Venturi nozzles atomize spray water
- Integral pressure control
- Electric and pneumatic actuation
- ANSI 300 to 2500 class

HORA

Turbine Bypass Systems

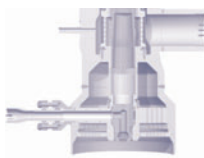

- Custom engineered
- 100% of capacity of turbine
- High/Intermediate/Low Pressure

ONYX

Pinch Valve



- Full round
- Single pinch
- Pre-pinch
- Air or electric actuators available
- Suitable for buried service
- ½" to 30"



PERSTA



High Pressure Valves

- Gate, globe and check
- Forged steel and alloy
- ½" and larger
- ANSI 900 to 2500 class

PURETORO



Rotary Valve Actuators

- High-cycle
- Accurate control
- ISO 5211 mounting
- Fail safe using auxiliary air tank

SCHUF/ FETTEROLF



Cam-Set and Stacey Line Blinds

- Positive isolation
- No flange separation
- Butt-weld and flanged ends
- Carbon and stainless steel
- 1" to 36"
- ANSI 150 to 1500 class

SCHUF

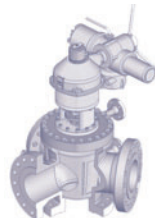

Coker IsoPlug Valves

- Materials CS and C12A (to 36")
- ANSI 150 to 900 class
- Switch Valves
- Materials CS and C12A
- 3 and 4 outlets at 120 or 90 degrees (to 24")
- ANSI 150 to 900 class

SCHUF



Severe Service Valves

- Flush mounted, bottom outlet, diverter, change over, control and lift
- plug, ram and disc type
- Diverter Valves
- 3/4/5 way options
- Metal to metal seated
- 1" to 10"
- ANSI 150 to 2500 class

SOMAS



Ball Segment Valves Butterfly Valves

- High-performance
- Stainless steel and exotic alloys
- Isolation and control
- Metal and soft seated
- 1" to 48"
- ANSI 150 to 300 class

STAFSJO

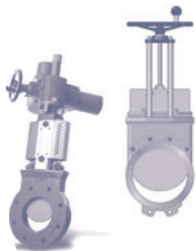

Knife Gate Valves

- Round and square port
- One way and bi-directional
- High-density cleaner valves
- Scavenger valves
- Sewage and pulp valves
- 2" to 48"

STAINLESS VALVE

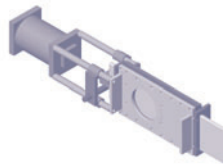

Slide Gate Valves

- Tight shut-off in severe applications
- Custom design flexibility
- Slurry applications

Head Office

126 Milner Avenue
Toronto, ON M1S 3R2
tel: 416-299-0780

Western Region

Office/Stocking Warehouse
6, 2221-41 Avenue NE
Calgary, AB T2E 6P2
tel: 403-229-3171

Field Offices

Atlantic Canada
Quebec
Ontario North
Ontario East
Alberta North
Alberta Central/South
Saskatchewan

Ext.

131
132
133
134
131
110
114

ISO 9001



Armour Valve

www.armourvalve.com
sales@armourvalve.com
1-800-268-3508
fax: 416-299-0394