



Armour Valve



District Heating
Health & Safety
Oil & Gas
Pulp & Slurry
Power & Steam
Waste Water Treatment

sales@armourvalve.com

1-800-268-3508
fax: 416-299-0394

Armour Valve Ltd. - Canada

Armour Valve 
www.armourvalve.com



Armour Valve



Your trusted supplier of specialty valves and process equipment

ARI



Air Release Valves

- High air discharge air release valve
- Patented conical body design
- Threaded and flanged ends
- 1" to 8"
- Combination air/vacuum
- Kinetic/automatic air release

AUMA



Electric Actuators and Valve Gearboxes

- Multi-turn, quarter-turn actuators and gear boxes
- Lever and linear actuators
- Up to 265,000 ft-lb

AZ-ARMATUREN

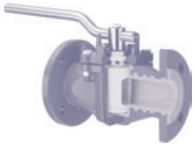

Plug Valves 2-way and Multi-Port Designs

- DI, SS and special alloys
- Sleeved and lines designs
- Self-lubricating/Maintenance free
- Chemical resistant
- Vacuum proof/Cavity free
- Plug easily adjusted
- T_{max}=200°C

BLAC INC.



Electro-Hydraulic Actuators, Control Systems & Power Units for Steam Turbines

- Power units and controls
- Linear and rotary applications
- Consultation available
- Field service capability

BOEHMER



2 Way and Multiport API Pipeline

- Fully welded 2 and 3 piece body
- District heating, gas isolation and control
- Biogas and natural gas
- Double block and bleed
- ½" to 36"
- ANSI 150 to 2500 class

CERA



Ceramic Ball and Sliding Disc Valves, Pipes and Elbows

- For high wear, corrosive and thermal shock applications
- Ceramic seats, balls and liners
- On/off and control applications
- 1" to 8"
- ANSI 150 to 300 class

CONVAL



Camseal Power Ball Valves

- Metal seated, unibody construction
- Zero leakage
- Top entry pressure seal
- Inline renewable
- ½" to 4"
- ANSI 1500 to 4500 class

CONVAL



Clampseal HP Globe Valves

- Globe, check, ball, gate, throttling and tandem blowdown valves
- ½" to 4"
- In-line repairable
- ANSI 900 to 4500 class

CONVAL



Throttling Valves

- Easy to read position indicator
- Pressure seal bonnet
- Replaceable seat/venturi
- Available in tandem configuration
- ½" through 3"
- Up to 2500 class

CONVAL/ HILTAP



High Pressure/High Temperature Vents and Drains

- Hydrocarbon drains
- Secondary leak containment



EBRO



Butterfly Valves

- Resilient seated
- PTFE lined
- High-performance
- Metal and PTFE seated
- Designed for abrasive services
- Wide range of materials available
- Wafer, double flanged and lugged
- 3/4" to 48"

EVS Valves



Metal Seated Ball Valves

- Tight shutoff
 - Fire safe, severe service
 - Various materials/end connections
 - 1/2" to 24"
 - ANSI 150 to 4500* class
- * Up to 900 class only for Power Industry

EVS Valves



Triple Offset Butterfly Valves

- Carbon steel, stainless steel body
- Flanged and lugged end connections
- 3" to 24"
- ANSI 150, 300, 600 class

FOSSIL POWER SYSTEMS



Ball Valves

- CSA/FM/API approved
- Automatic or manual
- 1/2" to 2" NPT and SW
- 1/2" to 6" Flanged
- Up to 300 class

FOSSIL POWER SYSTEMS



Aquarian Electronic Level Gauges

- Conductivity sensing
- Modified Swagelok probes
- Alarms and boiler trips
- Up to 3000 psi

FOSSIL POWER SYSTEMS



Aquarian Visual Level Gauges

- Wide range of visibility
- Bi-colour LED illumination
- Thermally compensated port seals
- Up to 3000 psi
- ASME Code compliant

HILTAP



RapidLok™ Series Safety Quick Couplings

- Metal to metal seal
- Leakproof operation
- Safe venting of residual pressure
- 1/4" to 6"
- Equal to ANSI 900/1500/2500

HOMESTEAD



AWWA Butterfly Valves

- Series 820 - 3" to 24"
- Series 830 - 24" to 144"
- Cast iron body
- Ductile iron disc
- Bi-directional bubble tight shut off
- Standard pressure class 150

HOMESTEAD



Eccentric Plug Valves

- For waste water and water applications
- Bi-directional design
- Full-size bore and epoxy-coated inside and out
- 3" to 72"

HORA



Feed Water Control Valves - High and Low Load Designs

- High and low lead designs
- Water, feedwater and steam
- Buttweld or flange connection
- Pneumatic, electric or hydraulic actuation
- 1/2" to 24"
- ANSI 150 to 2500 class



HORA



Steam Conditioning Valves for Combined Pressure Reducing and Desuperheating

- Globe, angle or z-style
- Carbon steel, stainless steel and other alloys
- Buttweld or flanged ends
- Up to 1500 class

HORA



Multi-Nozzle Desuperheaters

- Venturi nozzles atomize spray water
- Integral pressure control
- Electric and pneumatic actuation
- ANSI 300 to 2500 class

HORA

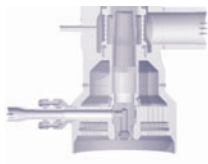

Turbine Bypass Systems

- Custom engineered
- 100% of capacity of turbine
- High/Intermediate/Low Pressure

HORA



Automatic Pump Recirculation Valves

- Minimum flow
- Ensures pump protection
- No pneumatic or electrical connections
- 2" to 10"
- ANSI 150 to 1500 class

INTERVALVE



Pressure Seal Bonnets

- Gate, globe, stop check and check valves
- 4" and larger
- ANSI 600 to 4500 class
- AWWA large bore butterfly valves

INTERVALVE

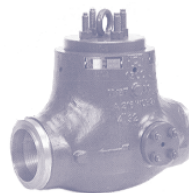

Tilting Disc Type Check Valves

- Design balanced for quick opening and immediate closing
- Optimum performance under all flow conditions
- 2½" to 24"
- ANSI 900 to 2500 class

ONYX



Pinch Valves

- Full round
- Single pinch
- Pre-pinched
- Air or electric actuators available
- Suitable for buried service
- ½" to 30"

ONYX



Duck Bill Check Valves

- Exterior and inline mounted
- Slip-on
- In-line mounted
- 1" to 24"

PERSTA



High Pressure Valves

- Gate, globe and check
- Forged steel and alloy
- ½" and larger
- ANSI 900 to 4500 class

PURETORQ



Rotary Valve Actuators

- High-cycle
- Accurate control
- ISO 5211 mounting
- Fail safe using auxiliary air tank



SCHUF/ FETTEROLF



Cam-Set and Stacey Line Blinds

- Positive isolation
- No flange separation
- Butt-weld and flanged ends
- Carbon and stainless steel
- 1" to 36"
- ANSI 150 to 1500 class

SCHUF



Coker IsoPlug Valves

- Materials CS and C12A (to 36")
 - ANSI 150 to 900 class
- ### Switch Valves
- Materials CS and C12A
 - 3 and 4 outlets at 120 or 90 degrees (to 24")
 - ANSI 150 to 900 class

SCHUF



Sampling Valves

- Metal to metal positive shut-off
- Thermal jacketed optional
- Ram and disc type
- PTFE or graphite packing
- ½" to 96"
- ANSI 150 to 2500 class
- Bottle systems available

SCHUF



Severe Service Valves

- Flush mounted, bottom outlet, diverter, change over, control and lift plug, ram and disc type
- ### Diverter Valves
- 3/4/5 way options
 - Metal to metal seated
 - 1" to 10"
 - ANSI 150 to 2500 class

SOMAS



Butterfly Valves

- High-performance
- Stainless steel and exotic alloys
- Isolation and control
- Metal and soft seated
- Inherently fire safe
- 3" to 48"
- ANSI 150 to 600 class

SOMAS



Ball Segment Valves

- Control and on/off
- Stainless steel and exotic alloys
- Metal and soft seated
- 1" to 10" standard, up to 28"
- ANSI 150 to 600 class

STAFSJO



HG Knife Gate Valves

- Bi-directional operation
- Through-going gate
- High pulp stock consistency
- 2" to 32"
- ANSI 150 class

STAFSJO



RKO Knife Gate Valves

- Round inlet and square outlet
- Suited for extreme process conditions
- Design minimizes clogging/choking
- High density cleaner valves
- Scavenger dump valves
- Cast iron and stainless steel
- 4" to 18"
- ANSI 150 class

STAFSJO



TVE Knife Gate Valves

- Transmitter and instrument isolation
- All stainless steel construction
- All stainless steel ratchet mechanism
- 3" ANSI 150 class

STAFSJO

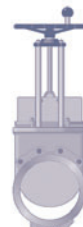

MV Knife Gate Valves

- Robust one-piece body design
- Suited for a wide range of applications
- Easy maintenance retainer ring
- Metal and soft seats
- 2" to 48"
- MV-E 2" to 40"
- MV-L 2" to 24"



Armour Valve



Your trusted supplier of specialty valves and process equipment

STAFSJO



BVA Knife Gate Valves

- Bi-directional
- Full-size bore and epoxy-coated inside and out
- Glasslining available
- Designed for water and waste water treatment
- 3" to 24"

STAINLESS VALVE

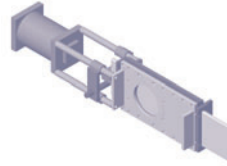

Slide Gate Valves

- Tight shut-off in severe applications
- Custom design flexibility
- Slurry applications

Head Office

126 Milner Avenue
 Toronto, ON M1S 3R2
 tel: 416-299-0780

Western Region

Office/Stocking Warehouse
 6, 2221-41 Avenue NE
 Calgary, AB T2E 6P2
 tel: 403-229-3171

Field Offices

Atlantic Canada 131
 Quebec 132
 Ontario North 133
 Ontario East 134
 Alberta North 131
 Alberta Central/South 110
 Saskatchewan 114

Ext.

ISO 9001



Armour Valve

www.armourvalve.com
sales@armourvalve.com
 1-800-268-3508
 fax: 416-299-0394